

ELEVATION CERTIFICATE

OMB No. 1660-0008
Expires March 31, 2012

Important: Read the instructions on pages 1-9.

SECTION A - PROPERTY INFORMATION

A1. Building Owner's Name <u>Joseph & Dorothy LaMantia</u>		For Insurance Company Use:
A2. Building Street Address (including Apt., Unit, Suite, and/or Bldg. No.) or P.O. Route and Box No. <u>116 Bonita Road</u>		Policy Number
City <u>Ocean Township</u> State <u>NJ</u> ZIP Code <u>08758</u>		Company NAIC Number
A3. Property Description (Lot and Block Numbers, Tax Parcel Number, Legal Description, etc.) <u>BLOCK 239, LOT 17.01</u>		
A4. Building Use (e.g., Residential, Non-Residential, Addition, Accessory, etc.) <u>RESIDENTIAL</u>		
A5. Latitude/Longitude: Lat. <u>39 46 35.6</u> Long. <u>74 11 21.1</u>		Horizontal Datum: <input type="checkbox"/> NAD 1927 <input checked="" type="checkbox"/> NAD 1983
A6. Attach at least 2 photographs of the building if the Certificate is being used to obtain flood insurance.		
A7. Building Diagram Number <u>6</u>		
A8. For a building with a crawlspace or enclosure(s):		A9. For a building with an attached garage:
a) Square footage of crawlspace or enclosure(s) <u>153</u> sq ft		a) Square footage of attached garage <u>1,128</u> sq ft
b) No. of permanent flood openings in the crawlspace or enclosure(s) within 1.0 foot above adjacent grade <u>1</u>		b) No. of permanent flood openings in the attached garage within 1.0 foot above adjacent grade <u>6</u>
c) Total net area of flood openings in A8.b <u>200</u> sq in		c) Total net area of flood openings in A9.b <u>1,200</u> sq in
d) Engineered flood openings? <input checked="" type="checkbox"/> Yes <input type="checkbox"/> No		d) Engineered flood openings? <input checked="" type="checkbox"/> Yes <input type="checkbox"/> No

SECTION B - FLOOD INSURANCE RATE MAP (FIRM) INFORMATION

B1. NFIP Community Name & Community Number <u>OCEAN, TOWNSHIP OF 340518</u>		B2. County Name <u>OCEAN</u>		B3. State <u>NEW JERSEY</u>	
B4. Map/Panel Number <u>34029C0414</u>	B5. Suffix <u>F</u>	B6. FIRM Index Date <u>09/29/2006</u>	B7. FIRM Panel Effective/Revised Date <u>09/29/2006</u>	B8. Flood Zone(s) <u>AE</u>	B9. Base Flood Elevation(s) (Zone AO, use base flood depth) <u>6</u>

B10. Indicate the source of the Base Flood Elevation (BFE) data or base flood depth entered in Item B9.
 FIS Profile FIRM Community Determined Other (Describe) _____

B11. Indicate elevation datum used for BFE in Item B9: NGVD 1929 NAVD 1988 Other (Describe) _____

B12. Is the building located in a Coastal Barrier Resources System (CBRS) area or Otherwise Protected Area (OPA)? Yes No
 Designation Date _____ CBRS OPA

SECTION C - BUILDING ELEVATION INFORMATION (SURVEY REQUIRED)

C1. Building elevations are based on: Construction Drawings* Building Under Construction* Finished Construction
 *A new Elevation Certificate will be required when construction of the building is complete.

C2. Elevations - Zones A1-A30, AE, AH, A (with BFE), VE, V1-V30, V (with BFE), AR, AR/A, AR/AE, AR/A1-A30, AR/AH, AR/AO. Complete Items C2.a-h below according to the building diagram specified in Item A7. Use the same datum as the BFE.
 Benchmark Utilized _____ Vertical Datum NAVD 1988
 Conversion/Comments _____

Check the measurement used.

a) Top of bottom floor (including basement, crawlspace, or enclosure floor) <u>4.0</u>	<input checked="" type="checkbox"/> feet <input type="checkbox"/> meters (Puerto Rico only)
b) Top of the next higher floor <u>13.0</u>	<input checked="" type="checkbox"/> feet <input type="checkbox"/> meters (Puerto Rico only)
c) Bottom of the lowest horizontal structural member (V Zones only) <u>N/A</u>	<input checked="" type="checkbox"/> feet <input type="checkbox"/> meters (Puerto Rico only)
d) Attached garage (top of slab) <u>3.5</u>	<input checked="" type="checkbox"/> feet <input type="checkbox"/> meters (Puerto Rico only)
e) Lowest elevation of machinery or equipment servicing the building (Describe type of equipment and location in Comments) <u>6.7</u>	<input checked="" type="checkbox"/> feet <input type="checkbox"/> meters (Puerto Rico only)
f) Lowest adjacent (finished) grade next to building (LAG) <u>3.0</u>	<input checked="" type="checkbox"/> feet <input type="checkbox"/> meters (Puerto Rico only)
g) Highest adjacent (finished) grade next to building (HAG) <u>3.3</u>	<input checked="" type="checkbox"/> feet <input type="checkbox"/> meters (Puerto Rico only)
h) Lowest adjacent grade at lowest elevation of deck or stairs, including structural support <u>2.5</u>	<input checked="" type="checkbox"/> feet <input type="checkbox"/> meters (Puerto Rico only)

SECTION D - SURVEYOR, ENGINEER, OR ARCHITECT CERTIFICATION

This certification is to be signed and sealed by a land surveyor, engineer, or architect authorized by law to certify elevation information. I certify that the information on this Certificate represents my best efforts to interpret the data available. I understand that any false statement may be punishable by fine or imprisonment under 18 U.S. Code, Section 1001.

Check here if comments are provided on back of form. Were latitude and longitude in Section A provided by a licensed land surveyor? Yes No

Certifier's Name <u>JAY F. PIERSON</u>		License Number <u>27492</u>	
Title <u>LAND SURVEYOR</u>	Company Name <u>EAST COAST ENGINEERING, INC</u>		
Address <u>508 MAIN STREET</u>	City <u>TOMS RIVER</u>	State <u>NJ</u>	ZIP Code <u>08753</u>
Signature <u>Jay F. Pierson</u>	Date <u>02/18/2011</u>	Telephone <u>732-244-3030</u>	

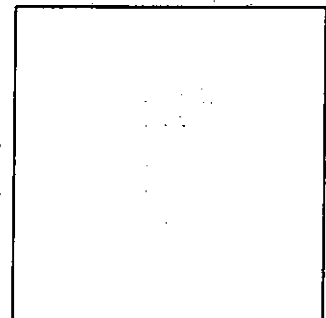

IMPORTANT: In these spaces, copy the corresponding information from Section A.	For Insurance Company Use:
Building Street Address (including Apt., Unit, Suite, and/or Bldg. No.) or P.O. Route and Box No. 116 Bonita Road	Policy Number
City TOWNSHIP OF OCEAN State NJ ZIP Code 08758	Company NAIC Number

SECTION D - SURVEYOR, ENGINEER, OR ARCHITECT CERTIFICATION (CONTINUED)

Copy both sides of this Elevation Certificate for (1) community official, (2) insurance agent/company, and (3) building owner.

Comments **LOWEST UTILITY SERVICING BUILDING IS A/C UNITS ON RAISED PLATFORM AT ELEV. 6.7. FLOOD OPENINGS IN ENCLOSURE AND GARAGE AREAS ARE ENGINEERED OPENINGS, VENTING 200 SF EACH. LATITUDE AND LONGITUDE OBTAINED BY GOOGLE EARTH.**

Signature  Date 02/18/2011

Check here if attachments

SECTION E - BUILDING ELEVATION INFORMATION (SURVEY NOT REQUIRED) FOR ZONE AO AND ZONE A (WITHOUT BFE)

For Zones AO and A (without BFE), complete Items E1-E5. If the Certificate is intended to support a LOMA or LOMR-F request, complete Sections A, B, and C. For Items E1-E4, use natural grade, if available. Check the measurement used. In Puerto Rico only, enter meters.

- E1. Provide elevation information for the following and check the appropriate boxes to show whether the elevation is above or below the highest adjacent grade (HAG) and the lowest adjacent grade (LAG).
- a) Top of bottom floor (including basement, crawlspace, or enclosure) is _____ feet meters above or below the HAG.
- b) Top of bottom floor (including basement, crawlspace, or enclosure) is _____ feet meters above or below the LAG.
- E2. For Building Diagrams 6-9 with permanent flood openings provided in Section A Items 8 and/or 9 (see pages 8-9 of Instructions), the next higher floor (elevation C2.b in the diagrams) of the building is _____ feet meters above or below the HAG.
- E3. Attached garage (top of slab) is _____ feet meters above or below the HAG.
- E4. Top of platform of machinery and/or equipment servicing the building is _____ feet meters above or below the HAG.
- E5. Zone AO only: If no flood depth number is available, is the top of the bottom floor elevated in accordance with the community's floodplain management ordinance? Yes No Unknown. The local official must certify this information in Section G.

SECTION F - PROPERTY OWNER (OR OWNER'S REPRESENTATIVE) CERTIFICATION

The property owner or owner's authorized representative who completes Sections A, B, and E for Zone A (without a FEMA-issued or community-issued BFE) or Zone AO must sign here. *The statements in Sections A, B, and E are correct to the best of my knowledge.*

Property Owner's or Owner's Authorized Representative's Name _____

Address _____ City _____ State _____ ZIP Code _____

Signature _____ Date _____ Telephone _____

Comments _____

Check here if attachments

SECTION G - COMMUNITY INFORMATION (OPTIONAL)

The local official who is authorized by law or ordinance to administer the community's floodplain management ordinance can complete Sections A, B, C (or E), and G of this Elevation Certificate. Complete the applicable item(s) and sign below. Check the measurement used in Items G8 and G9.

- G1. The information in Section C was taken from other documentation that has been signed and sealed by a licensed surveyor, engineer, or architect who is authorized by law to certify elevation information. (Indicate the source and date of the elevation data in the Comments area below.)
- G2. A community official completed Section E for a building located in Zone A (without a FEMA-issued or community-issued BFE) or Zone AO.
- G3. The following information (Items G4-G9) is provided for community floodplain management purposes.

G4. Permit Number	G5. Date Permit Issued	G6. Date Certificate Of Compliance/Occupancy Issued
-------------------	------------------------	---

G7. This permit has been issued for: New Construction Substantial Improvement

G8. Elevation of as-built lowest floor (including basement) of the building: _____ feet meters (PR) Datum _____

G9. BFE or (in Zone AO) depth of flooding at the building site: _____ feet meters (PR) Datum _____

G10. Community's design flood elevation _____ feet meters (PR) Datum _____

Local Official's Name _____ Title _____

Community Name _____ Telephone _____

Signature _____ Date _____

Comments _____

Check here if attachments

Building Photographs

See Instructions for Item A6.

Building Street Address (including Apt., Unit, Suite, and/or Bldg. No.) or P.O. Route and Box No. 116 Bonita Road	For Insurance Company Use: Policy Number
City TOWNSHIP OF OCEAN State NJ ZIP Code 08758	Company NAIC Number

If using the Elevation Certificate to obtain NFIP flood insurance, affix at least two building photographs below according to the instructions for Item A6. Identify all photographs with: date taken; "Front View" and "Rear View"; and, if required, "Right Side View" and "Left Side View." If submitting more photographs than will fit on this page, use the Continuation Page on the reverse.



116 Bonita Road, FRONT



116 Bonita Road, REAR

Building Photographs

Continuation Page

Building Street Address (including Apt., Unit, Suite, and/or Bldg. No.) or P.O. Route and Box No. 116 Bonita Road	For Insurance Company Use: Policy Number
City TOWNSHIP OF OCEAN State NJ ZIP Code 08758	Company NAIC Number
If submitting more photographs than will fit on the preceding page, affix the additional photographs below. Identify all photographs with: date taken; "Front View" and "Rear View"; and, if required, "Right Side View" and "Left Side View."	



116 Bonita Road, A/C UNITS

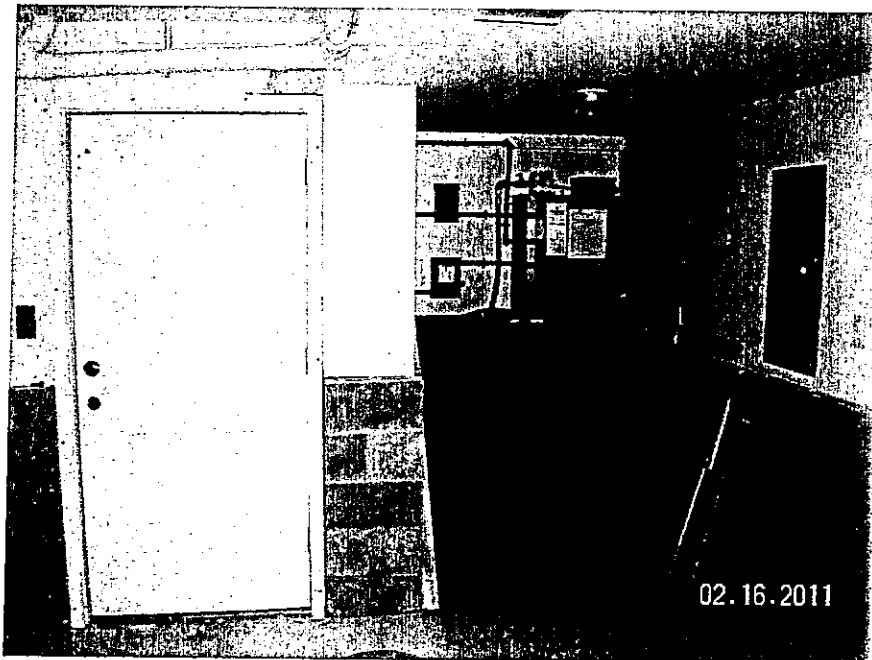

116 Bonita Road, ELEVATOR UTILITIES

[Community letterhead]

Memo of Review For Correctness and Completion

The attached FEMA Elevation Certificate has been reviewed by this office.
The items noted below are not correct on the attached form and should read as entered on this page.

SECTION A - PROPERTY INFORMATION		For Insurance Company Use:
A1. Building Owner's Name	<i>Joseph + Dorothy La Mantia</i>	Policy Number
A2. Building Street Address (including Apt., Unit, Suite, and/or Bldg. No.) or P.O. Route and Box No.	<i>116 Bonita Road</i>	Company NAIC Number
City	<i>Ocean Township</i>	ZIP Code
	<i>MD</i>	<i>08758</i>
A3. Property Description (Lot and Block Numbers, Tax Parcel Number, Legal Description, etc.)		
<i>Block 239 Lot 17.01</i>		
A4. Building Use (e.g., Residential, Non-Residential, Addition, Accessory, etc.) <i>Residential</i>		
A5. Latitude/Longitude: Lat. <i>39°43'</i> Long <i>74°12.1'</i> Horizontal Datum: <input type="checkbox"/> NAD 1927 <input checked="" type="checkbox"/> NAD 1983		
A6. Attach at least 2 photographs of the building if the Certificate is being used to obtain flood insurance.		
A7. Building Diagram Number <i>6</i>		
A8. For a building with a crawlspace or enclosure(s):		A9. For a building with an attached garage:
a) Square footage of crawlspace or enclosure(s)	<i>153</i> sq ft	a) Square footage of attached garage
b) No. of permanent flood openings in the crawlspace or enclosure(s) within 1.0 foot above adjacent grade	<i>1</i>	b) No. of permanent flood openings in the attached garage within 1.0 foot above adjacent grade
c) Total net area of flood openings in A8.b	<i>200</i> sq in	c) Total net area of flood openings in A9.b
d) Engineered flood openings? <input checked="" type="checkbox"/> Yes <input type="checkbox"/> No		d) Engineered flood openings? <input checked="" type="checkbox"/> Yes <input type="checkbox"/> No

SECTION B - FLOOD INSURANCE RATE MAP (FIRM) INFORMATION

B1. NFIP Community Name & Community Number		B2. County Name		B3. State	
<i>Ocean Township of 340518</i>		<i>Ocean</i>		<i>New Jersey</i>	
B4. Map/Panel Number	B5. Suffix	B6. FIRM Index Date	B7. FIRM Panel Effective/Revised Date	B8. Flood Zone(s)	B9. Base Flood Elevation(s) (Zone AO, use base flood depth)
<i>34029C0414</i>	<i>F</i>	<i>9/29/2006</i>	<i>9/29/2006</i>	<i>AE</i>	<i>6</i>
B10. Indicate the source of the Base Flood Elevation (BFE) data or base flood depth entered in Item B9.					
<input type="checkbox"/> FIS Profile <input checked="" type="checkbox"/> FIRM <input type="checkbox"/> Community Determined <input type="checkbox"/> Other (Describe) _____					
B11. Indicate elevation datum used for BFE in Item B9: <input type="checkbox"/> NGVD 1929 <input checked="" type="checkbox"/> NAVD 1988 <input type="checkbox"/> Other (Describe) _____					
B12. Is the building located in a Coastal Barrier Resources System (CBRS) area or Otherwise Protected Area (OPA)? <input type="checkbox"/> Yes <input checked="" type="checkbox"/> No					
Designation Date _____ <input type="checkbox"/> CBRS <input type="checkbox"/> OPA					

SECTION C - BUILDING ELEVATION INFORMATION (SURVEY REQUIRED)

C1. Building elevations are based on: Construction Drawings* Building Under Construction* Finished Construction
*A new Elevation Certificate will be required when construction of the building is complete.

Local Official's Name	<i>Edmond Alvarez</i>	Title	<i>Construction Official</i>
Community Name	<i>Ocean Township</i>	Telephone	<i>609-693-3487</i>
Signature	<i>Ed Alvarez</i>	Date	<i>10/12/12</i>
Comments	<i>Correction for finished Construction</i>		

116 Bonita

[Community letterhead]

Memo of Review For Correctness and Completion

The attached FEMA Elevation Certificate has been reviewed by this office. The items noted below are not correct on the attached form and should read as entered on this page.

SECTION A - PROPERTY INFORMATION		For Insurance Company Use:
A1. Building Owner's Name	Joseph + Dorothy La Mantia	Policy Number
A2. Building Street Address (including Apt., Unit, Suite, and/or Bldg. No.) or P.O. Route and Box No.	116 Bonita Road	Company NAIC Number
City	Ocean Township	
State	MD	
ZIP Code	08758	
A3. Property Description (Lot and Block Numbers, Tax Parcel Number, Legal Description, etc.)	Block 239 Lot 17.01	
A4. Building Use (e.g., Residential, Non-Residential, Addition, Accessory, etc.)	Residential	
A5. Latitude/Longitude: Lat. 39.435 Long. 74.121.1	Horizontal Datum: <input type="checkbox"/> NAD 1927 <input checked="" type="checkbox"/> NAD 1983	
A6. Attach at least 2 photographs of the building if the Certificate is being used to obtain flood insurance.		
A7. Building Diagram Number	6	
A8. For a building with a crawlspace or enclosure(s):		A9. For a building with an attached garage:
a) Square footage of crawlspace or enclosure(s)	153 sq ft	a) Square footage of attached garage
b) No. of permanent flood openings in the crawlspace or enclosure(s) within 1.0 foot above adjacent grade	1	b) No. of permanent flood openings in the attached garage within 1.0 foot above adjacent grade
c) Total net area of flood openings in A8.b	200 sq in	c) Total net area of flood openings in A9.b
d) Engineered flood openings? <input checked="" type="checkbox"/> Yes <input type="checkbox"/> No		d) Engineered flood openings? <input checked="" type="checkbox"/> Yes <input type="checkbox"/> No

SECTION B - FLOOD INSURANCE RATE MAP (FIRM) INFORMATION

B1. NFIP Community Name & Community Number	B2. County Name	B3. State
Ocean Township of 340518	Ocean	New Jersey
B4. Map/Panel Number	B5. Suffix	B6. FIRM Index Date
34029C0414	F	9/29/2006
B7. FIRM Panel Effective/Revised Date	B8. Flood Zone(s)	B9. Base Flood Elevation(s) (Zone AO, use base flood depth)
9/29/2006	AE	6
B10. Indicate the source of the Base Flood Elevation (BFE) data or base flood depth entered in Item B9.		
<input type="checkbox"/> FIS Profile <input checked="" type="checkbox"/> FIRM <input type="checkbox"/> Community Determined <input type="checkbox"/> Other (Describe) _____		
B11. Indicate elevation datum used for BFE in Item B9: <input type="checkbox"/> NGVD 1929 <input checked="" type="checkbox"/> NAVD 1988 <input type="checkbox"/> Other (Describe) _____		
B12. Is the building located in a Coastal Barrier Resources System (CBRS) area or Otherwise Protected Area (OPA)? <input type="checkbox"/> Yes <input checked="" type="checkbox"/> No		
Designation Date _____ <input type="checkbox"/> CBRS <input type="checkbox"/> OPA		

SECTION C - BUILDING ELEVATION INFORMATION (SURVEY REQUIRED)

C1. Building elevations are based on: Construction Drawings* Building Under Construction* Finished Construction
 *A new Elevation Certificate will be required when construction of the building is complete.

Local Official's Name	Signature
Edmond Alvarez	Edmond Alvarez
Community Name	Title
Ocean Township	Construction Official
Signature	Telephone
Edmond Alvarez	609-693-3487
Comments	Date
Correction for finished construction	10/12/12